

M03450-08 FERRULE REPLACES M03400-08

IMPROVED PERFORMANCE & RELIABILITY

Manuli Hydraulics is globally renowned for the quality, performance and reliability of its hydraulic connectors. However, even the best products can still be made better and as technologies develop there is often the opportunity to further improve our products.

For this reason we have evolved the design of the M03400-08 ferrule in order to further improve the reliability and robustness of the sealing. The new M03450-08 ferrule will be phased-in starting Q1 2023, and the existing M03400-08 ferrule will no longer be available.

FEATURES:

- Improved strength and sealing performance with the new generation of high-performance hydraulic hoses
- Upgraded design for better tube compression control

PLEASE NOTE:

- M03400-08 ferrules will no longer be available to order after March 2023.
- Delivery of new M03450-08 ferrules will follow stock rotation criteria (ie: total consumption of M03400-08 stock) - *Manuli Customer Service will provide details during order processing.*
- **Crimping data for M03450-08 is different from the original M03400-08 data (see following page for details). Please ensure that you update all relevant assembly instructions accordingly.**
- SCE and SCS crimping data will be updated alongside the next release of the Crimping Chart booklet (Q2 2023).

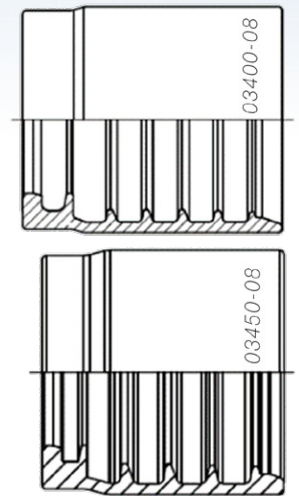

There are also some minor dimensional differences between the two ferrules.

The amended technical data is shown below:

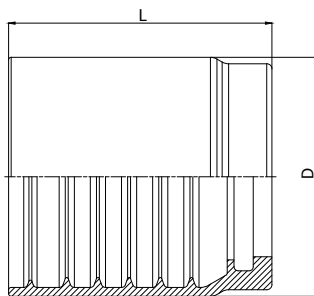

M03400/M03450

NO-SKIVE FERRULE FOR WIRE BRAID HOSES

PART. REF.	HOSE BORE					DIMENSIONS mm						
	DN	Dash	inch			D	L					
M03400-08	12	- 8	1/2"			29.0	34.0					
M03450-08	12	- 8	1/2"			30.3	31.0					

Modified crimping data for the M03450-08 ferrules is as follows:

Product Ref.	Hose Type	DN	Insert Type	Crimp Type	M03400-08		M03450-08	
					Crimp Diameter (mm)	Die No.	Crimp Diameter (mm)	Die No.
H01006012* H02004012*	TRACTOR/1SN	12	Multifit	No Skive	23,5	21	24,0	21
H1007012*	ROCKMASTER/1SN	12	Multifit	No Skive	23,5	21	24,0	21
H01124012*	FIREEND	12	Multifit	No Skive	23,5	21	24,0	21
H01154012*	SHIELDMASTER/21	12	Multifit	No Skive	23,1	21	24,0	21
H01166012* H01166A12*	FOREMASTER/21	12	Multifit	No Skive	23,1	21	24,0	21
H01173012* H01125012*	GOLDENISO/21 ANTIWEAR	12	Multifit	No Skive	23,1	21	24,0	21
H02003012* H02008012*	K-JET	12	Multifit	No Skive	22,6	21	23,7	21
H01084012*	LYTE-FLEX	12	Multifit	No Skive	23,5	21	24,4	24
H01030012*	ROCKMASTER/2SC	12	Multifit	No Skive	23,5	21	24,4	24
H01A78012* H01A79012*	SUPERJET/PLUS	12	Multifit	No Skive	23,5	21	24,4	24
H01126012* H01142012*	GOLDENISO/28 ANTIWEAR	12	Multifit	No Skive	23,5	21	24,4	24
H01155012*	SHIELDMASTER/28	12	Multifit	No Skive	23,5	21	24,4	24
H01167012* H01167A12*	FOREMASTER/28	12	Multifit	No Skive	23,5	21	24,4	24
H01162012*	SAFEMASTER/2SC	12	Multifit	No Skive	23,5	21	24,4	24
H01102A12*	ETERNITY/2	12	Multifit	No Skive	23,5	21	24,2	21
H01164012* H01164A12*	INFINITY	12	Multifit	No Skive	24,0	21	24,2	21
H10119012*	SHIELDMASTER/35	12	Multifit	No Skive	23,5	21	24,5	24
H10133012*	FOREMASTER/35	12	Multifit	No Skive	23,5	21	24,5	24
H01159012*	CRYOFLEX/35	12	Multifit	No Skive	23,5	21	24,5	24
H1027012*	TRACTOR/2SN	12	Multifit	No Skive	24,3	21	25,0	24
H01038012* H01177012*	ROCKMASTER/2SN	12	Multifit	No Skive	24,3	21	25,0	24
H01165012*	SAFEMASTER/2SN	12	Multifit	No Skive	24,3	21	25,0	24

M00920-06 FERRULE REPLACES M00910-06

IMPROVED PERFORMANCE & RELIABILITY

Manuli Hydraulics is globally renowned for the quality, performance and reliability of its hydraulic connectors. However, even the best products can still be made better and as technologies develop there is often the opportunity to further improve our products.

For this reason we have evolved the design of the M00910-06 ferrule in order to further optimise the design. The new M00920-06 ferrule will be phased-in starting Q1 2023, and the existing M00910-06 ferrule will no longer be available to order after February 2023.

Delivery of new M00920-06 ferrules will follow stock rotation criteria - *contact Customer Service for more details.*

FEATURES:

- Slightly larger uncrimped diameter to enable easier mounting on hose



- Same robust sealing performance and fatigue resistance

Crimping data for the new M00920-06 ferrule is identical to the original M00910-06 data. Future releases of the crimping booklet will only reference the new M00920-06 ferrule.

If you have any questions regarding this change, please contact your local Manuli Hydraulics sales representative.